

Engine Powered Forklift 2.5 - 3.5 ton

BT cargo

C4D/G250E

C4D/G300E

C4D/G350E



Engine Powered Forklift 2.5-3.5 ton

Truck specifications					C4D250E/C4G250E	C4D300E/C4G300E	C4D350E/C4G350E
Identification	1.1	Manufacturer			BT	BT	BT
	1.2	Model			C4D250E/C4G250E	C4D300E/C4G300E	C4D350E/C4G350E
	1.3	Drive			Diesel/GPL	Diesel/GPL	Diesel/GPL
	1.4	Operator type			Rider seated	Rider seated	Rider seated
	1.5	Load capacity/rated load	Q	kg	2500	3000	3500
	1.6	Load centre	c	mm	500	500	500
	1.8	Load distance, centre of drive axle to fork	x	mm	460 ¹⁾	465 ¹⁾	478 ¹⁾
	1.9	Wheelbase	y	mm	1750	1750	1820
	Weight	2.1	Service weight		kg	4000/3890	4580/4470
2.2		Axle load, with load, front/rear		kg	5890-610/5830-560	6730-850/6670-800	7510-930/7450-880
2.3		Axle load, without load, front/rear		kg	2010-1990/1950-1940	2050-2530/1990-2480	2050-2890/1990-2840
Tyres	3.1	Tyres: Cushion (C), Pneumatic (PN), Superelastic (SE), Twin (TW)			SE/PN/SE.TW/PN.TW	SE/PN/SE.TW/PN.TW	SE/PN/SE.TW/PN.TW
	3.2	Tyre size, front			7,00-12/7,00-12/ 7,00-12/7,00-12	27x10-12/27x10-12/ 7,00-12/7,00-12	27x10-12/27x10-12/ 7,00-12/7,00-12
	3.3	Tyre size, rear			6,50-10/6,50-10	6,50-10/6,50-10	23x9-10 ²⁾ /6,50-10
	3.5	Wheels, number front/rear (x=driven wheels)			2x-4x/2	2x-4x/2	2x-4x/2
	3.6	Track width, front	b ₁₀	mm	1042-1042/1153-1205	1002-1038/1153-1205	1002-1038/1153-1205
	3.7	Track width, rear	b ₁₁	mm	1000	1000	1000
	Dimensions	4.1	Tilt of mast/fork carriage forward/backward	α/β	deg	5°/9°	5°/10°
4.2		Height, mast lowered	h ₁	mm	2252	2252	2252
4.3		Free lift	h ₂	mm	100	100	100
4.4		Lift	h ₃	mm	3160	3160	3160
		Lift height	h ₂₃	mm	3200	3205	3210
4.5		Height, mast extended	h ₄	mm	3805	3833	3833
4.7		Height of overhead guard (cab)	h ₆	mm	2200	2200	2200
4.8		Seat height/stand height	h ₇	mm	1150	1150	1150
4.12		Coupling height	h ₁₀	mm	450	450	450
4.19		Overall length	l ₁	mm	3568 ¹⁾	3697 ¹⁾	3796 ¹⁾
4.20		Length to face of forks	l ₂	mm	2568 ¹⁾	2697 ¹⁾	2796 ¹⁾
4.21		Overall width	b ₁	mm	1215/1250	1254/1313	1254/1313
4.22		Fork dimensions	s/e/l	mm	40/120/1000	45/120/1000	50/150/1000
4.23		Fork carriage DIN 15 173, class/type A, B			IIA	IIIA	IIIA
4.24		Fork-carriage width	b ₃	mm	1100	1100	1100
4.31		Ground clearance, with load, below mast	m ₁	mm	152	152	152
4.32	Ground clearance, centre of wheelbase	m ₂	mm	170	170	170	
4.33	Aisle width for pallets 1000 x 1200 crossways	A _{st}	mm	3911 ¹⁾	4022 ¹⁾	4305 ¹⁾	
4.34	Aisle width for pallets 800 x 1200 lengthways	A _{st}	mm	4110 ¹⁾	4221 ¹⁾	4435 ¹⁾	
4.35	Turning radius	W _a	mm	2250	2356	2510	
4.36	Internal turning radius	b ₁₃	mm	677	677	693	
Performance data	5.1	Travel speed, with/without load		km/h	20,0/21,0	20,0/21,0	20,0/21,0
	5.2	Lift speed, with/without load		m/s	0,49/0,51	0,47/0,51	0,45/0,50
	5.3	Lowering speed, with/without load		m/s	<0,59	<0,59	<0,59
	5.5	Drawbar pull, with/without load		N	17000/16100	17000/16400	17000/16400
	5.7	Gradeability, with/without load		%	25/31	21/28	18/26
	5.10	Service brake			Hydraulic	Hydraulic	Hydraulic
Combustion engine	7.1	Engine manufacturer/type			Kubota V3600/Toyota 4Y		
	7.2	Engine power acc. to ISO 1585		kW	44/37	44/37	44/37
	7.3	Rated speed		1/min	2200/2400	2200/2400	2200/2400
	7.4	No. of cylinders/displacement		cm ³	4-3620/4-2237	4-3620/4-2237	4-3620/4-2237
Others	8.1	Type of drive control			Stepless hydrostatic	Stepless hydrostatic	Stepless hydrostatic
	8.2	Operating pressure for attachments		bar	180	180	180

1) With sideshift = +25 mm

2) SE

Performance data and dimensions are nominal and subject to tolerances. Specifications are subject to change without notice. Please obtain the latest specifications before contracting products.

Mast dimensions and rated capacities

BT cargo

Mast			Duplex				Duplex FFL		Triplex				Triplex FFL				
C4D250E/ C4G250E	Lift height	h_{23}	3200	3700	4200	5000	2970	3200	4245	5005	5605	6805	4350	4500	5000	5600	6100
	Lift	h_3	3160	3660	4160	4960	2930	3160	4305	4965	5565	6765	4310	4460	4960	5560	6060
	Height, mast lowered	h_1	2252	2502	2752	3202	2132	2252	2132	2352	2552	3052	2132	2182	2352	2552	2752
	Height, mast extended	h_4	3805	4305	4805	5632	3625	3855	4972	5632	6232	7532	5005	5155	5655	6255	6755
	Free lift	h_2	100	100	100	100	1437	1557	45	45	45	45	1437	1487	1657	1857	2057

Mast			Duplex				Duplex FFL		Triplex				Triplex FFL				
C4D300E/ C4G300E	Lift height	h_{23}	3205	3705	4205	5005	2975	3205	4250	5010	5610	6810	4355	4505	5005	5605	6105
	Lift	h_3	3160	3660	4160	4960	2930	3160	4305	4965	5565	6765	4310	4460	4960	5560	6060
	Height, mast lowered	h_1	2252	2502	2752	3202	2132	2252	2132	2352	2552	3052	2132	2182	2352	2552	2752
	Height, mast extended	h_4	3833	4333	4833	5633	3626	3856	4978	5638	6238	7532	5006	5156	5656	6256	6756
	Free lift	h_2	100	100	100	100	1436	1556	45	45	45	45	1436	1486	1656	1856	2056

Mast			Duplex				Duplex FFL		Triplex				Triplex FFL				
C4D350E/ C4G350E	Lift height	h_{23}	3210	3710	4210	5010	2980	3210	4355	4015	5615	6815	4360	4510	5010	5610	6110
	Lift	h_3	3160	3660	4160	4960	2930	3160	4305	4965	5565	6765	4310	4460	4960	5560	6060
	Height, mast lowered	h_1	2252	2502	2752	3202	2132	2252	2132	2352	2552	3052	2132	2182	2352	2552	2752
	Height, mast extended	h_4	3833	4333	4833	5633	3626	3856	4978	5638	6238	7532	5006	5156	5656	6256	6756
	Free lift	h_2	100	100	100	100	1436	1556	45	45	45	45	1436	1486	1656	1856	2056

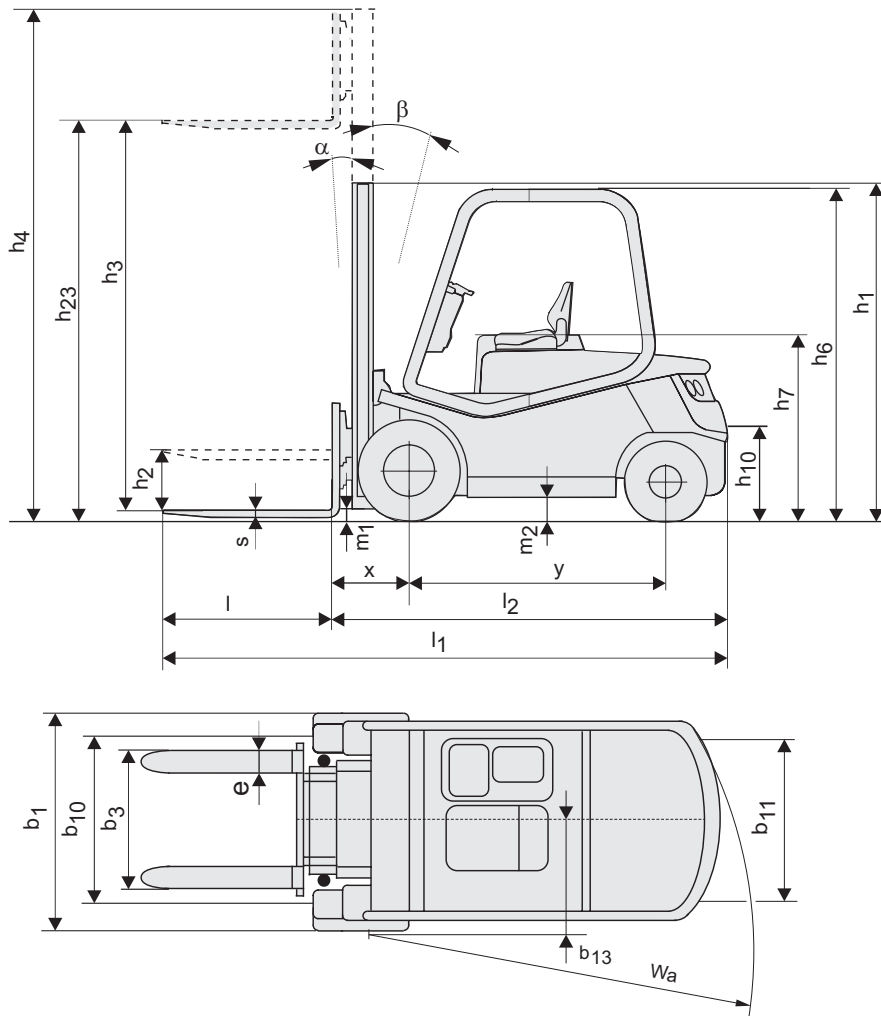

Standard equipment:

- Hydrostatic transmission
- Long forks (1000 mm)
- Tilting mast
- Side-shift
- Balanced pedals control
- Clear-view mast
- Driver detection system
- Adjustable steering wheel



TP-Technical Publications, Sweden — 745577-040, version 1, 1203

